

Plat of Survey

of

Lot 29 in Block 1 of Delmar,

a subdivision located in the Southwest 1/4 of Section 27, Town 2 North,
Range 16 East, Town of Delavan, Walworth County, Wisconsin.

Surveyed for: **Cook Contruction & Design, LLC**

1407 Racine Street - Suite C
Delavan, Wisconsin. 53115

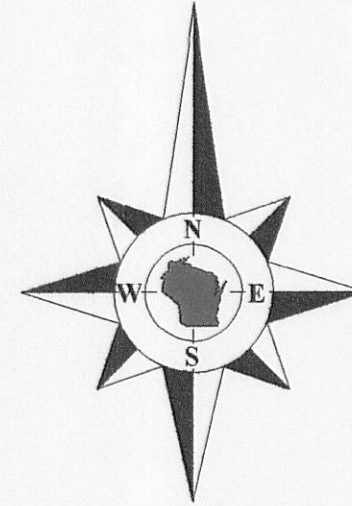

Bearings referenced to the Northwestern
line of Mason Street, recorded as
N32°23'E on the plat of Delmar.

Survey Date: April 18, 2011.
Revisions:

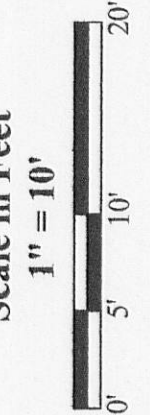

Jensen & Olson Land Surveying, LLC

45 South Wisconsin Street * P.O. Box 322 * Elkhorn, Wisconsin. 53121
Telephone: (262) 723-3434 * Facsimile: (262) 723-8044
Email: jensen.olson@elknet.net

Legend
Found Iron Pipe in Concrete
Found Iron Pipe
Recorded Information
Utility Pole
Asphalt Surface
Concrete Surface
Gravel Surface
Patio Blocks or Flagstone

Sheet 1 of 1 Sheets

Job Reference Number

2011.022

2011.022

Notes:

- 1) This survey plat is not certified unless signed and sealed in red ink.
- 2) This survey is subject to Wisconsin lien laws. This Plat of Survey is the notice of intent to file lien. Lien waiver required.

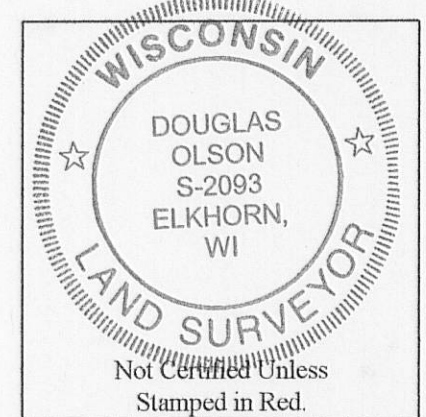

Lot 29 Tax Parcel FDM 00007A

0.185 Acre
8,078 Sq.Ft.

House
No. 2513

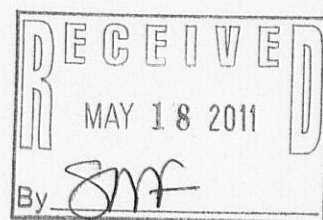

Copyright 2011 by Jensen & Olson Land Surveying, LLC.

All rights reserved. No part of this survey plat may be reproduced or transmitted in any form by any means - graphic, electronic, or mechanical, including photocopying, tracing, or information storage and retrieval systems - without permission in writing from Douglas G. Olson, Jensen & Olson Land Surveying, LLC.

I, Douglas G. Olson, Wisconsin Registered Land Surveyor, do hereby certify that this survey was performed by me, or under my direction in full compliance with the owner's/agent's instructions and Chapter A-E 7 of the Wisconsin Administrative Code "Minimum Standards for Property Surveys"; and that this map is an accurate representation thereof to the best of my knowledge and belief.

Douglas G. Olson
Wisconsin Registered Land Surveyor - 2093

FDM-7A

210-4857